



# Siena Twist

## 360° Car Seat Instruction Manual

### NOTICE

This is an "i-Size" Enhanced Child Restraint System.

This is an "i-Size" booster seat Enhanced Child Restraint System.

i-Size ISOFIX car seat suitable 40cm–150cm

Approved to Regulation No.129, for use in, "i-Size compatible" vehicle seating positions as indicated by vehicle manufacturers in the vehicle users' manual.

If in doubt, contact [hello@amanababy.com](mailto:hello@amanababy.com).

DO NOT USE REARWARD FACING ECRS IN SEATING POSITIONS WHERE THERE IS AN ACTIVE FRONTAL AIRBAG INSTALLED. UNIVERSAL Vehicle ISOFIX Child Restraint Systems. IMPORTANT – DO NOT USE FORWARD FACING BEFORE THE CHILD'S AGE EXCEEDS 15 months (Refer to instructions).

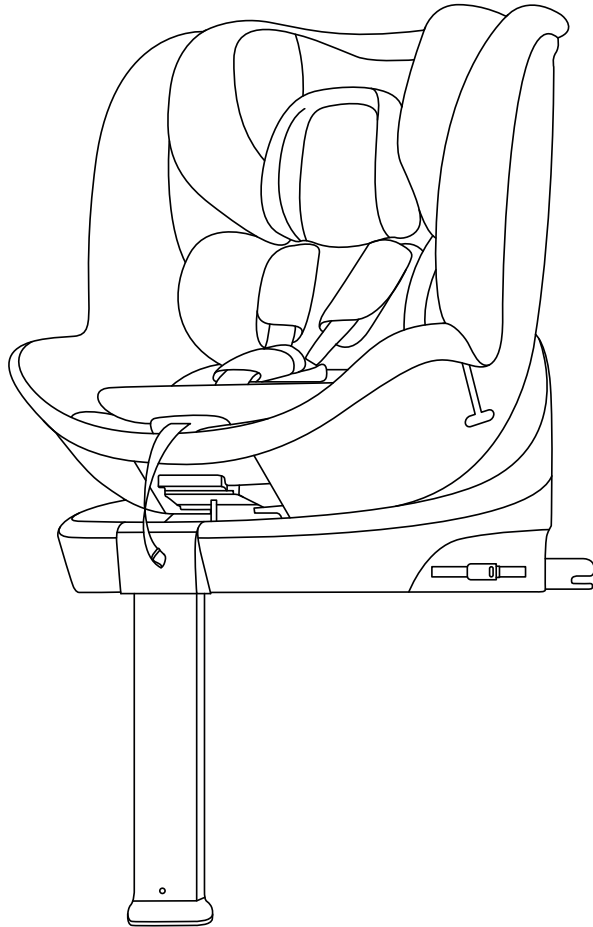

# **Instruction Manual**

**Siena Twist 360° Car Seat**

Child height: 40–150cm

Weight: 0–36kg

Suitable age: Birth – approx. 12 Years



Rearward facing 40–105cm: ISOFIX + Support leg + harness

Forward facing 76–105cm: ISOFIX + Support leg + harness

Forward facing 105–150cm: ISOFIX attachments + adult safety-belt or adult safety-belt only

Please carefully read this manual and follow each step to ensure a comfortable travel and best protection for your child. Please keep the instruction manual in the instruction manual storage compartment at the back of the seat body at all times.

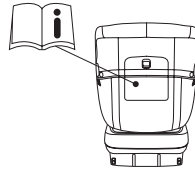

## Notice

Notice regarding i-Size category Enhanced Child Restraint Systems (40–105cm). This is an i-Size Enhanced Child Restraint System. It is approved according to UN Regulation No. 129, for use in, i-Size compatible vehicle seating positions as indicated by vehicle manufacturers in the vehicle users' manual. If in doubt, consult either the Enhanced Child Restraint System manufacturer or the retailer.

Notice regarding i-Size booster seat category Enhanced Child Restraint Systems (105–150cm). This is an i-Size booster seat Enhanced Child Restraint System. It is approved according to UN Regulation No. 129, for use primarily in “i-Size seating positions” as indicated by vehicle manufacturers in the vehicle user’s manual. If in doubt, consult either the Enhanced Child Restraint System manufacturer or the retailer.

**⚠ WARNING:** NOT TO USE REARWARD FACING ECRS IN SEATING POSITIONS WHERE THERE IS AN ACTIVE FRONTAL AIRBAG INSTALLED.

**⚠ IMPORTANT!** DO NOT USE FORWARD FACING BEFORE THE CHILD’S AGE EXCEEDS 15 months (refer to instructions).



# Contents

<b>1. Structure</b>	<b>2</b>
<b>2. Precautions For Product Use</b>	<b>3</b>
<b>3. Safety Warning</b>	<b>5</b>
3.1 Understand The Product	5
<b>4. Use In The Vehicle</b>	<b>6</b>
4.1 Install In The Car Correct Position	6
4.2 Adjusting The Headrest	6
4.3 Checking The Shoulder Strap Height	7
4.4 Usage Of Buckle	7
4.5 Adjusting The Harness	8
4.6 Storing Shoulder Pads With Chest Pad And Buckle	9
4.7 Usage Of The Support Leg	10
4.8 Adjust the ISOFIX attachments	11
4.9 Rotating The Car Seat	12
4.10 Reclining The Car Seat	13
<b>5. Installation</b>	<b>14</b>
5.1 Notice Before Installation	14
5.2 Rearward-facing Installation 40–105cm	15
5.3 Forward-facing Installation 76–105cm	17
5.4 Forward-facing Installation 105–150cm Option 1	19
5.5 Forward-facing Installation 105–150cm Option 2	21
<b>6. Main Technical Parameters</b>	<b>23</b>
<b>7. Maintenance And Cleaning</b>	<b>23</b>
7.1 Daily Maintenance	23
7.2 Washing Instruction	23
7.3 Remove and assemble the fabric cover	24

# 1. Structure

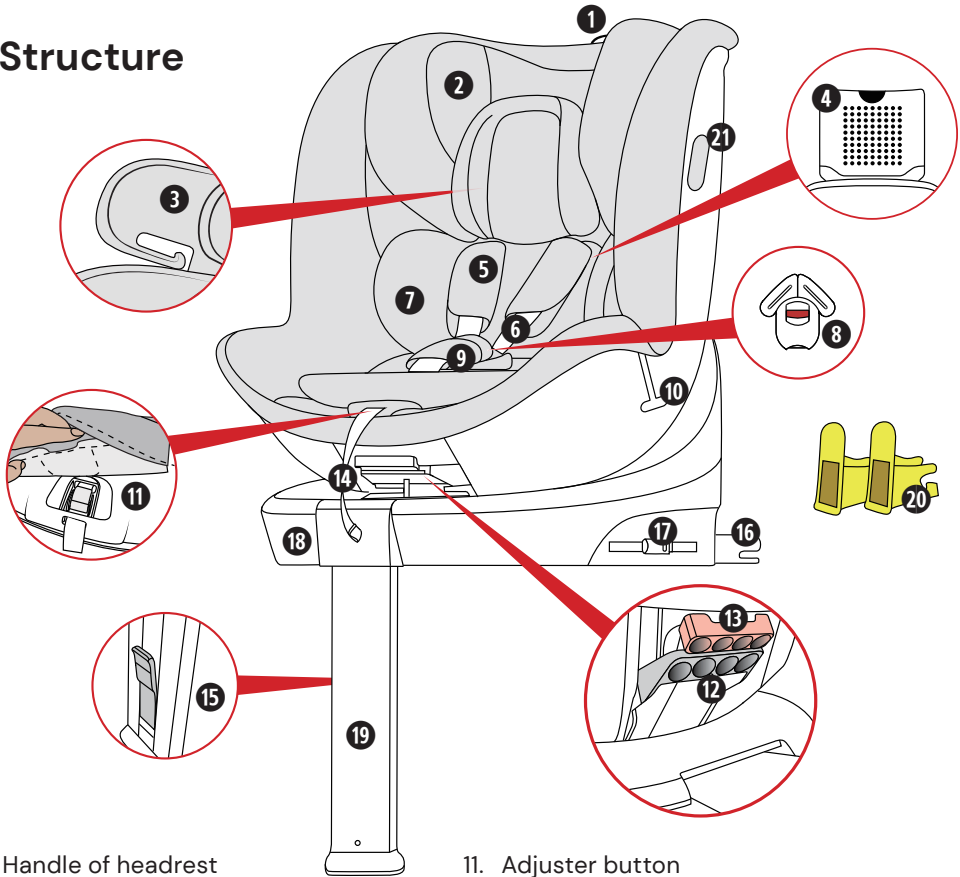

- |   |   |
|---|---|
| 1. Handle of headrest                                 | 11. Adjuster button                       |
| 2. Headrest   | 12. Angle adjuster                        |
| 3. The guide groove of the headrest                   | 13. Rotation adjuster                     |
| 4. Rear cover board (instruction manual inside)       | 14. Harness adjuster strap                |
| 5. Shoulder sleeves                                   | 15. Support leg release button            |
| 6. Shoulder strap                                     | 16. ISOFIX attachment                     |
| 7. Comfortable cushion                                | 17. ISOFIX release button                 |
| 8. Buckle   | 18. Base                                  |
| 9. Crotch pad   | 19. Support leg                           |
| 10. The guide groove of the body (Used for 105-150cm) | 20. ISOFIX guide sleeve                   |
|   | 21. Side impact protect system (Optional) |

## 2. Precautions For Product Use

To ensure that your child is protected to a greater degree, please read the following instructions carefully:

1. This product can be rearward-facing used for children with a height of 40–105cm (Weight: 0–18kg), using ISOFIX+ Support leg to fix the child restraint system.
2. This product can also be forward-facing used by 5–point safety system for children with a height of 76–105cm (Weight: 9–18kg), using ISOFIX+ Support leg to fix the child restraint system.
3. This product can also be forward-facing used for children with a height of 105–150cm (Weight: 15–36kg), using adult three–point belt to fix the child restraint system, or using ISOFIX and adult three–point belt together to fix the child restraint system.
4. Do not use any load bearing contact points other than those described in the instructions and marked in the child restraint when in 105–150cm.
5. Please keep for future reference, a storage compartment for the instructions is located on the back of the car seat.
6. Do not use this car seat at home. It has not been designed for home use and should only be used in your car.
7. Do not use rearward facing car seat in seating positions where there is an active frontal airbag installed, death or serious injury can occur.
8. For the reason of safety, the car seat must be fixed inside the vehicle using ISOFIX anchorages even if you do not put your child inside the car seat.
9. The rigid items and plastic parts of a car seat shall be so located and installed that they are not liable, during everyday use of the vehicle to become trapped by a moveable seat or in a door of the vehicle.
10. Any straps holding the restraint to the vehicle should be tight.
11. Any support-leg should be in contact with the vehicle floor.
12. Any straps restraining the child should be adjusted to the child's body.
13. Straps should not be twisted.
14. Ensure that any lap strap is worn low down, so that the pelvis is firmly engaged, shall be stressed.
15. **DO NOT** continue to use this car seat after it has suffered any violent crash. Replace immediately as there may be invisible structural damage from the crash.

16. It's dangerous to make any alterations or additions to the device without the approval of the Type Approval Authority, also dangerous not to follow closely the installation instructions provided by the manufacturer.
17. When the chair is not provided with a textile cover, the chair should be kept away from sunlight, otherwise it may be too hot for the child's skin.
18. Don't leave your child in the car seat unattended.
19. Any luggage or other object liable to cause injuries in the event of a collision shall be properly secured.
20. The ECRS shall not be used without the cover.
21. The seat cover should not be replaced with any other than the one recommended by the manufacturer, because the cover constitutes an integral part of the restraint performance.
22. The instructions shall be retained on the device for its life period or in the vehicle handbook in the case of built-in restraints.
23. The user shall also be referred to the vehicle manufacturer's handbook.
24. Never use a second-hand product, as you can never be certain what was happened to it.
25. **DO NOT** leave this child restraint unsecured in your vehicle because an unsecured child restraint can be thrown around and may injure occupants in a sharp turn, sudden stop, or collision. Remove it if not in regular use.
26. Consult the retailer for issues concerning maintenance, repair and part replacement.





### 3. Safety Warning

**⚠ IMPORTANT!**

In order to ensure the safety of your child, please read the relevant instructions carefully to avoid dangerous situations.

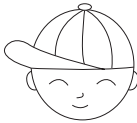
This is a height of 40-150cm product, suitable for children from 0-36kg.

**⚠ DO NOT** use forward facing before the child’s age exceeds 15 months.

3.1 Understand The Product		
 <p>40-105cm</p>	 <p>76-105cm</p>	 <p>105-150cm</p>
Rearward-facing position R	Forward-facing position 123456	Forward-facing position 1
 <p>ISOFIX+ Support Leg</p>	 <p>ISOFIX+ Support Leg</p>	 <p>ISOFIX+ Adult Safety Belt Only</p>

This car seat conforms to National standard: GB27887- 2011 and European ECE R129/03



## 4. Use In The Vehicle

### 4.1 Install In The Car Correct Position

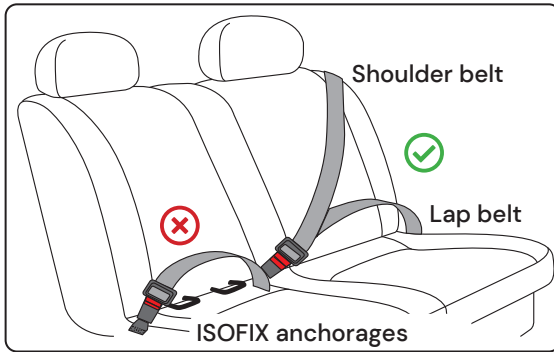

Only suitable if the approved vehicles are fitted with 3 point safety-belt, approved to UN/ ECE Regulation No.16 or other equivalent standards.

- ✓ Proper installation
- ✗ Improper installation

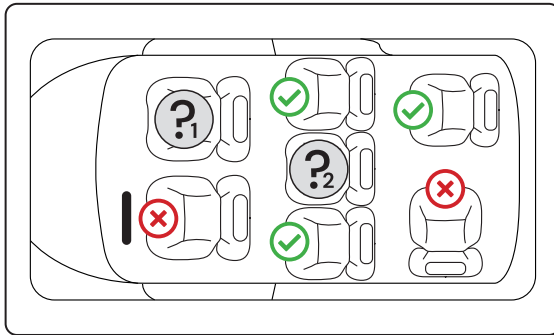

?<sub>1</sub> Not to be used in seating positions where an active frontal airbag is installed.

?<sub>2</sub> Only to be used on this seat if ISOFIX anchorages are fitted.

### 4.2 Adjusting The Headrest

As shown in the picture, you can adjust the headrest up and down by pulling on the headrest adjustment tab ❶, and adjust the headrest to a position suitable for the child's head.

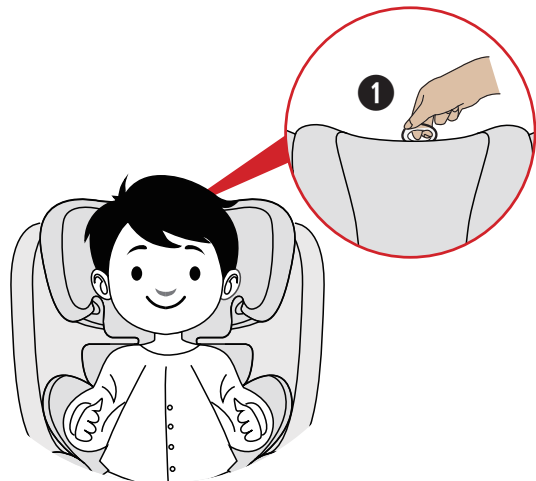

### 4.3 Checking The Shoulder Strap Height

Always check that the shoulder straps are at the correct height for your child. The child's shoulder straps should always be threaded through the slots in the cover and seat shell that are closest to the top of your child's shoulders.

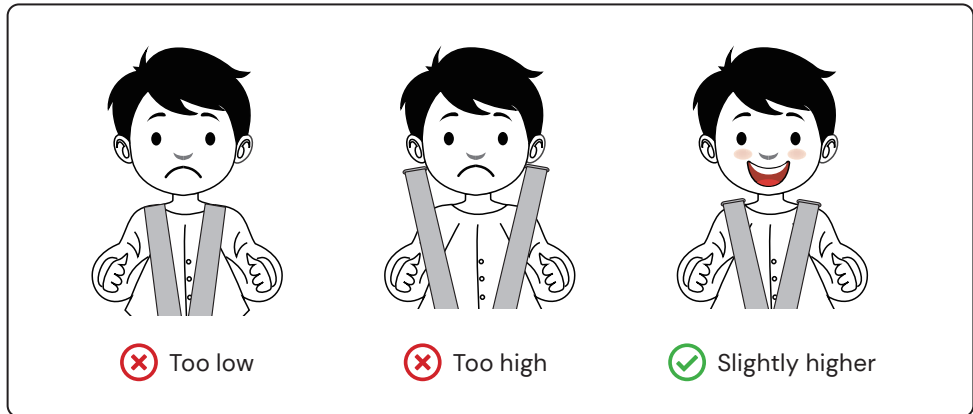

### 4.4 Usage Of Buckle

- Get the left and the right pieces of buckle together.
- Insert the two pieces into the slot of the buckle. At the same time, hearing “click” means the buckle gets stuck, pull the pieces of the buckle and check whether the buckle is locked correctly.
- To release the safety belts, press the red button.

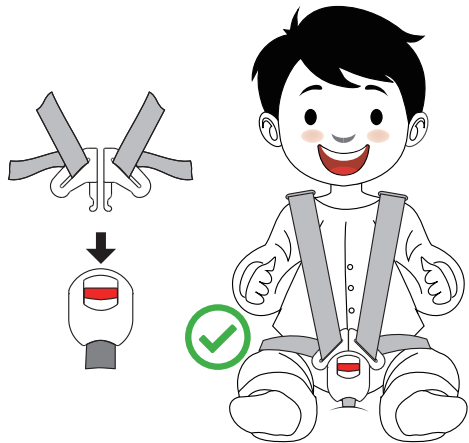

## 4.5 Adjusting The Harness

### Loosen the harness 11

The harness can be slackened by pressing the adjuster (under the seat cover) on the front of the seat. Press down the adjuster as you grip the two harness with your other hand. Pull the harness towards you to loosen the harness.

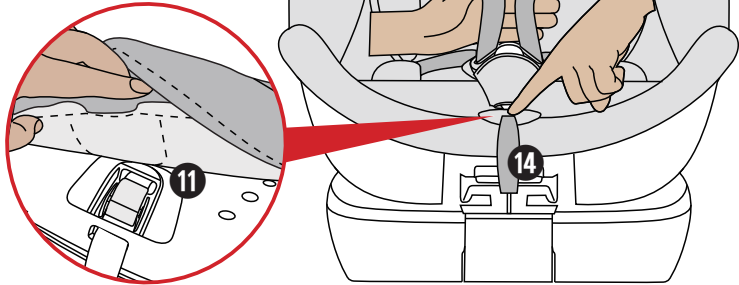

### Tighten the harness 14

Pull the harness upward to remove the slack from the lap sections of the harness then pull the front stretch belt until the harness is fully tightened.

### ⚠ IMPORTANT!

The harness should be adjusted as tightly as possible without causing discomfort to your child. A loose harness can be dangerous.

Check the harness adjuster and tighten each time when the child is placed in the seat.

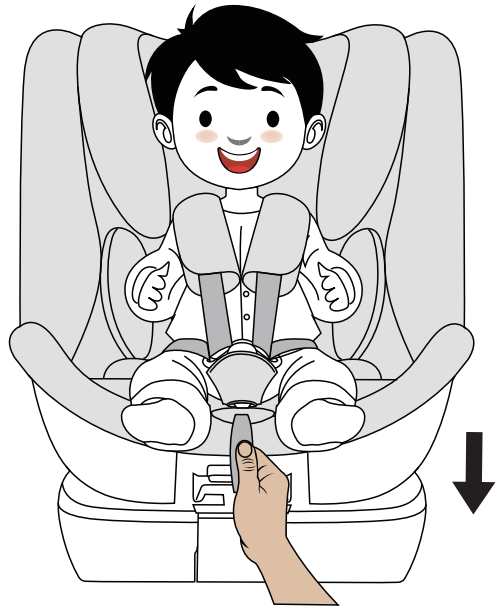

## 4.6 Storing Shoulder Pads With Chest Pad And Buckle

 Suitable for children in height 105–150cm.

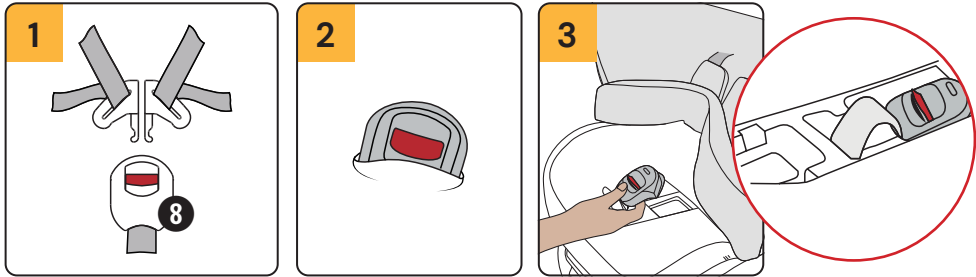

Storage of buckle:

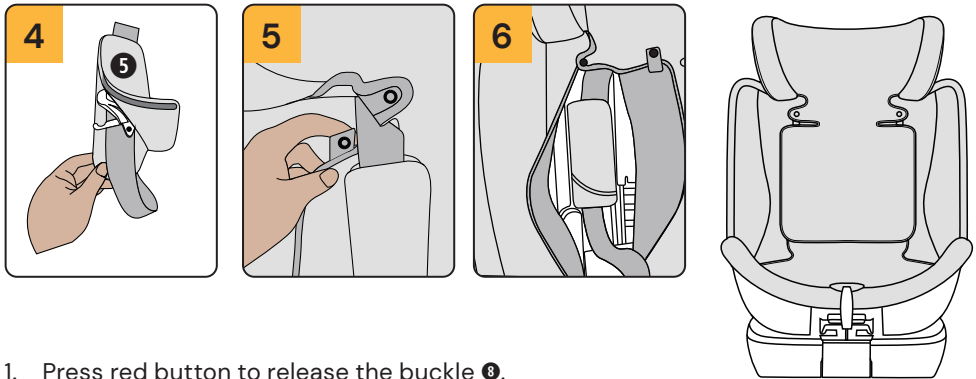

Storage of shoulder straps and sleeves:



The effect after storage

1. Press red button to release the buckle .
2. Take the buckle out of the crotch pad.
3. Then lift the seat cover, pull out the buckle from the cover hole, and put it into the seat groove for storage.
4. Tear the Velcro of the two shoulder sleeves , put the buckle inserts in order and store them in the shoulder sleeves.
5. Loosen the snap button on both sides of the headrest cover to expose the internal structure of the seat.
6. Store the sorted shoulder sleeves in the grooves inside the seat.

## 4.7 Usage Of The Support Leg

**⚠** When child height in 40-105cm, the support leg is in the usage state.

- Lift the bottom of the seat and push the support leg forward from the groove with your hand.

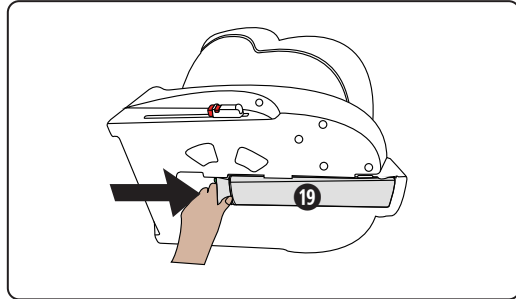

- Push it to the front end and then take the support leg out, let it be perpendicular to the ground and hear a sound of "click".

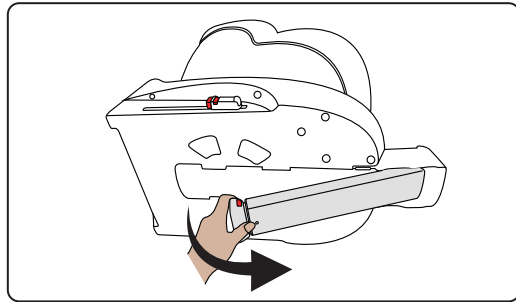

- To adjust the length of the support leg 19, press and hold the adjustment button on the support leg 15, then adjust the length up and down until it hits the car ground. The bottom of the support leg will turn green.

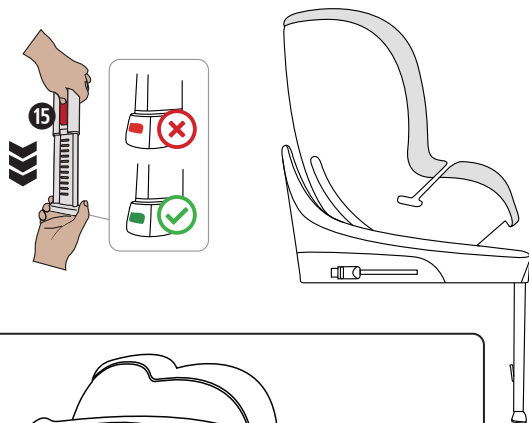

- ⚠** When child height in 105-150cm, the support leg is in the stowed state. Note: When putting away the support leg, press and hold the bottom support leg first to prevent loosening, and push the front end of the support leg in at the same time.

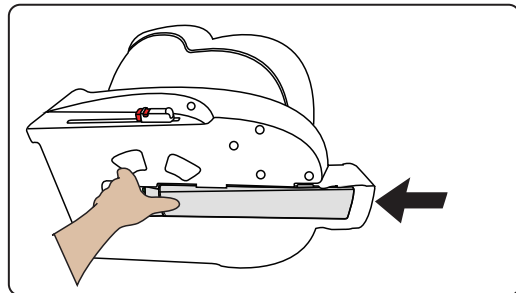

## 4.8 Adjust the ISOFIX attachments

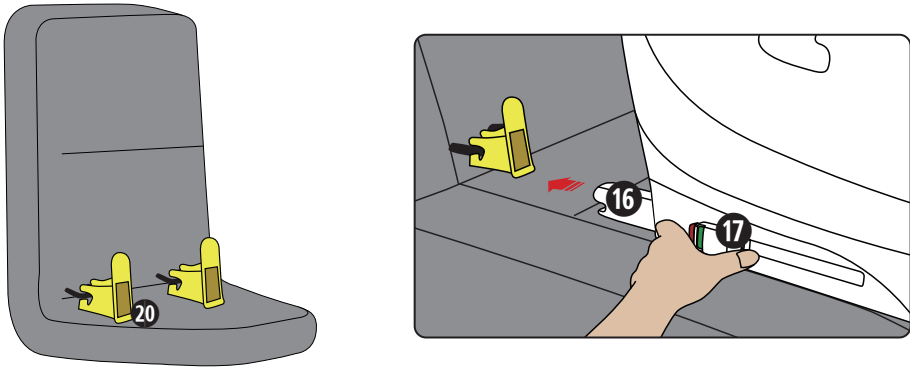

- First install the two ISOFIX guide sleeves 20 to the ISOFIX attachment of the vehicle.  
⚠ If your vehicle seat is equipped with ISOFIX guide sleeves there is no need to install it.
- The ISOFIX attachments can be adjusted for many positions to fit the different positions of ISOFIX 16 low anchorages depending from car seat.
- Press down the release button 17 to adjust ISOFIX attachment of both sides to the longest. Snap the ISOFIX into the ISOFIX guide sleeve. Make sure that you have heard a “click” and the ISOFIX latching indication shows GREEN.
- If you want to release the ISOFIX attachments, just installation of the ISOFIX attachments is finished.
- Push the red release button of the ISOFIX chuck at the direction as shown, the ISOFIX chuck will be released.

⚠ After the ISOFIX chuck is installed, push the child restraint forwards until it is tight against the car seat. Now, the ISOFIX base is installed in place.

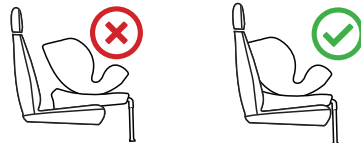

## 4.9 Rotating The Car Seat

Find the rotation adjuster button **3**, lift up and rotate the body at the same time (both sides can be rotated).

When you hear a sound of “click”, the rotation adjuster automatically retracts, indicating that the gear is in place.

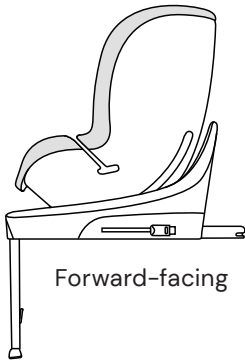
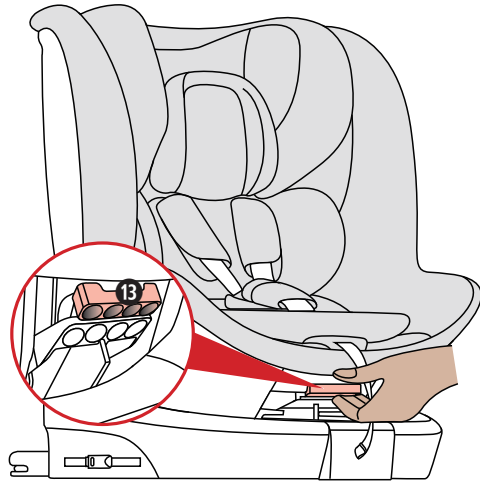

Forward-facing

76–150cm  
Weight: 9–36kg  
Rotate to adjust  
before effect.

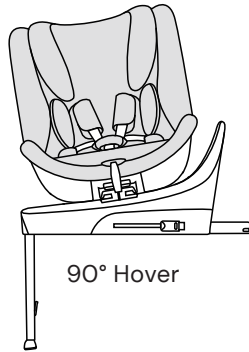

90° Hover

**⚠** This position can only  
be used when installing  
the child. Do not keep this  
state when driving.





Rearward-facing

40–105cm  
Weight: 0–18kg  
Effect after rotation  
adjustment.

## 4.10 Reclining The Car Seat

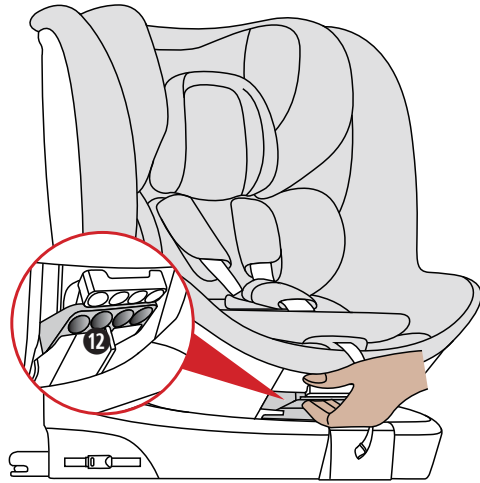

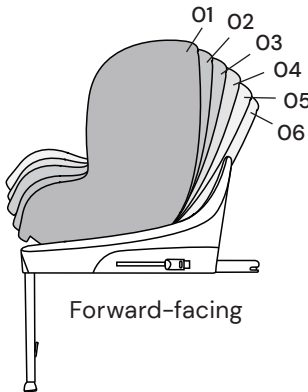

Find the angle adjuster ⑫, lift up and adjust the seat angle forward or backward at the same time.



Rearward-facing	Forward-facing
	
40–105cm Weight: 0–18kg Effect after rotation adjustment.	76–105cm, 9–18kg Adjust to Gear 01/02/03/04/05/06 105–150cm, 15–36KG Adjust to Gear 01

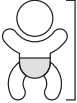
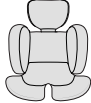

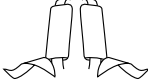
# 5. Installation

5.1 Notice Before Installation					
 Height	 Small Headrest & Cushion	 Triangle Sponge	 Shoulder Pads / Straps	 Crotch Pad	 Buckle (Sketch Map)
40-87cm	✓	✓	✓	✓	✓
87-105cm	✗	✗	✓	✓	✓
105-150cm	✗	✗	✗	✗	✗

## 5.2 Rearward-facing Installation 40–105cm

Usage: ISOFIX+ Support Leg



1. Raise the seat slightly, take out the support legs from the grooves of the base, and then make the support legs 19 90° perpendicular to the ground (see section 4.7 on page 10).

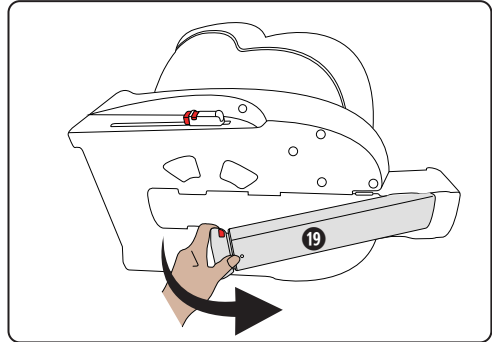

2. If the vehicle is not equipped with ISOFIX guide sleeve 20, it needs to be installed as shown in the figure.

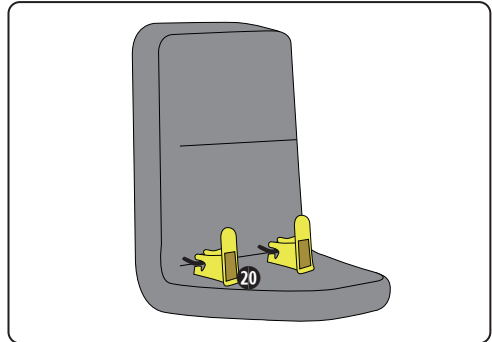

3. Push ISOFIX on both sides of the base and clip it into the ISOFIX guide sleeve. When a “click” is heard, the ISOFIX release button 17 is displayed in green colour.

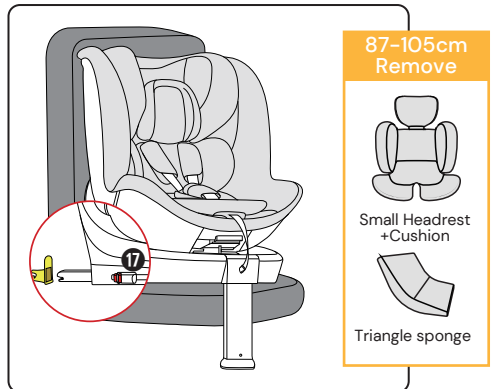

4. Press and hold the adjustment button on the support leg 19 to adjust the length up and down until it contacts the vehicle ground, and the bottom of the support leg will be shown green.

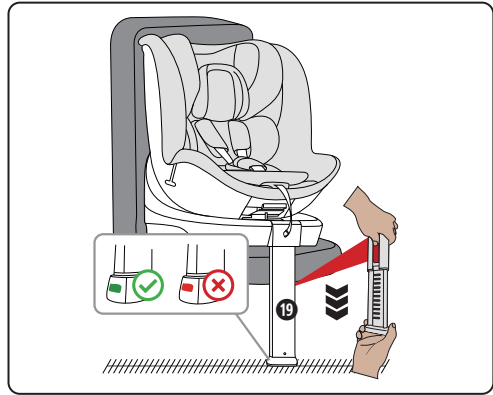

5. Turn the rotation adjuster 12 to rotate the seat to the 90° hover direction, then place the child on the safety seat, lock the buckle 8, and tighten the front tether 14.

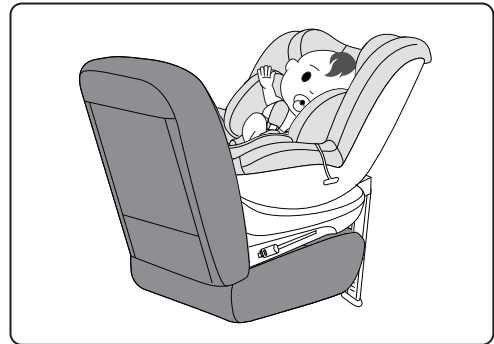

6. Turn the rotation adjuster 12 and adjust the 90° hover state to rearward-facing. The vehicle can only drive after hearing the “click” sound.

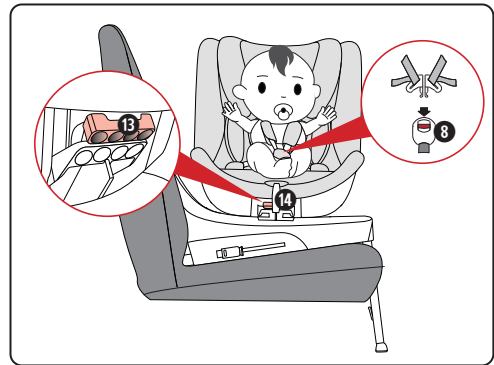

- ⚠ On the premise of not causing discomfort to children, tighten the shoulder belt as much as possible.
- ⚠ The crotch strap should be as low as possible and should be located close to the crotch, not the abdomen.
- ⚠ To ensure the comfort of your child, the safety belt must not be twisted.
- ⚠ **PAY ATTENTION!** Do not drive when the safety seat is in the location of 90° hover.

### 5.3 Forward-facing Installation 76–105cm

Usage: ISOFIX+ Support Leg



1. First, open the support leg 19 to 90°.

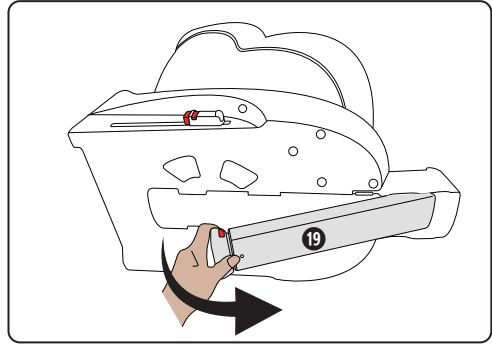

2. If the vehicle is not equipped with ISOFIX guide sleeve 20, it needs to be installed as shown in the figure.

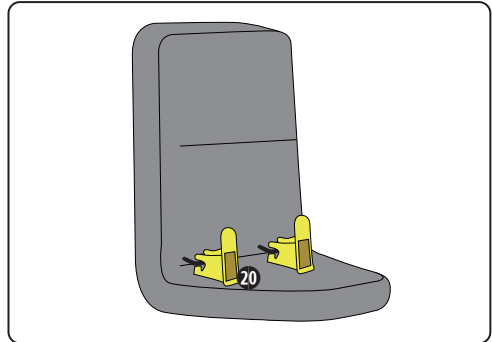

3. Push ISOFIX on both sides of the base and clip it into the ISOFIX guide sleeve. When a “click” is heard, the ISOFIX release button 17 is displayed in green colour.

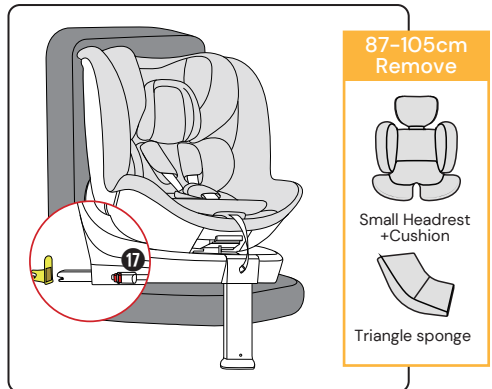

- Press and hold the adjustment button on the support leg 19 to adjust the length up and down until it contacts the vehicle ground, and the bottom of the support leg will be shown green.

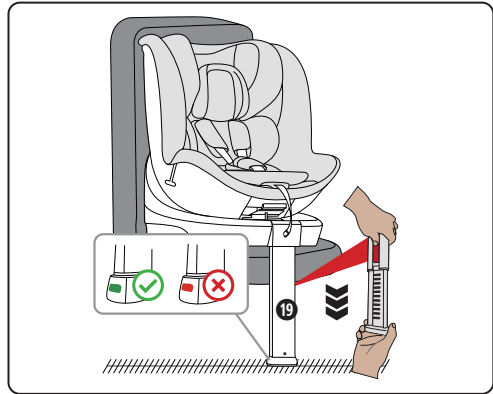

- Place the child in the safety seat, lock the buckle 8, and tighten the front tether 14.

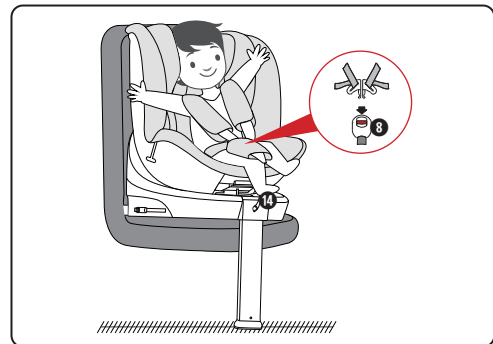

- Adjust the angle adjuster under the seat to choose a comfortable angle.

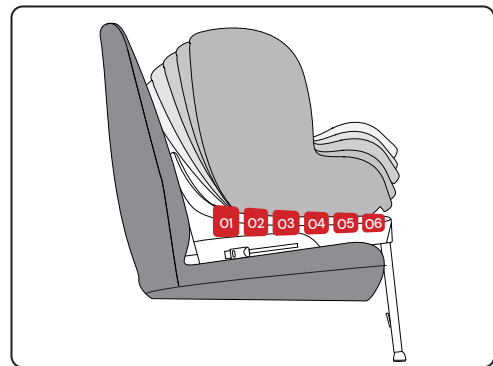

- ⚠ On the premise of not causing discomfort to children, tighten the shoulder belt as much as possible.
- ⚠ The crotch strap should be as low as possible and should be located close to the crotch, not the abdomen.
- ⚠ To ensure the comfort of your child, the safety belt must not be twisted.
- ⚠ **PAY ATTENTION!** Do not drive when the safety seat is in the location of 90° hover.

## 5.4 Forward-facing Installation 105–150cm Option 1

Usage: ISOFIX+ 3 Point Belt



### 1. Store the support leg 19:

- Press and hold the adjustment button on the support leg 15, and stow the support leg;
- Then lift the seat and fold the support leg back into the seat bottom groove;
- Finally, push the front protruding part inward.

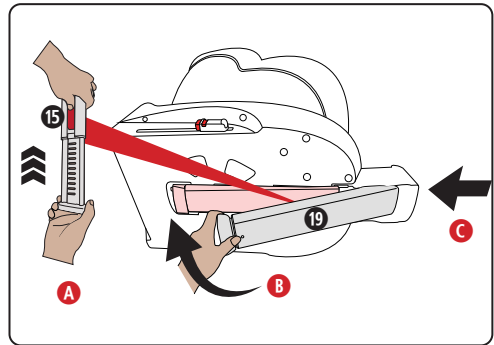

- ### 2. If the vehicle is not equipped with ISOFIX guide sleeve 20, it needs to be installed as shown in the figure.

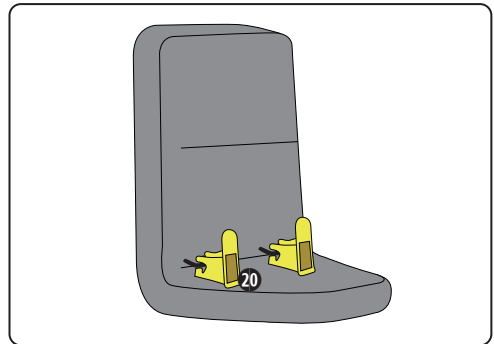

- ### 3. Push ISOFIX on both sides of the base and clip it into the ISOFIX guide sleeve. When a “click” is heard, the ISOFIX release button 17 is displayed in green colour.

See section 4.6 “Storing Shoulder Pads With Chest Pad And Buckle” on page 9 to remove the parts.

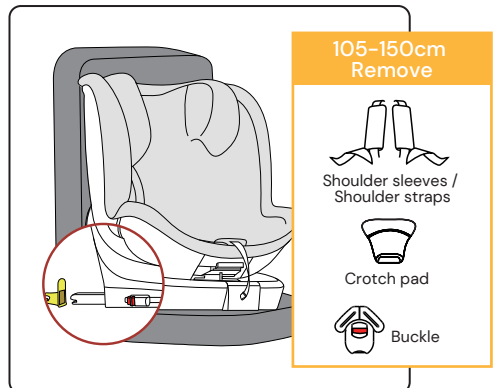

- Put the child into the safety seat, adjust the headrest up and down according to the height of child.

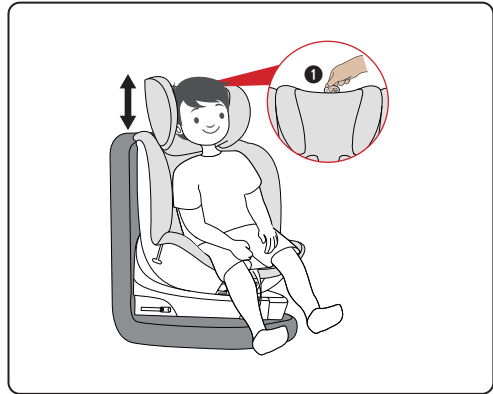

- Pull out the adult 3-point belt:
  - Clip the vehicle shoulder belt into the belt guide hook of the headrest, and then clip vehicle shoulder and lap belt together into the belt guide slot on the side of the seat, finally lock the buckle.

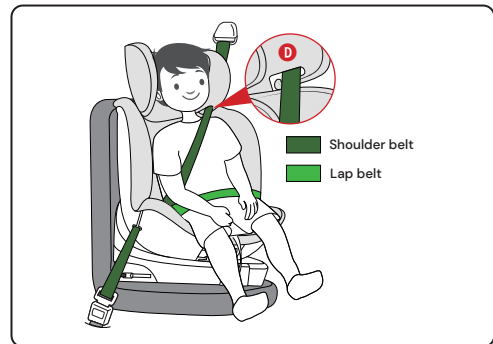

- ⚠ On the premise of not causing discomfort to children, tighten the shoulder belt as much as possible.
- ⚠ The crotch strap should be as low as possible and should be located close to the crotch, not the abdomen.
- ⚠ To ensure the comfort of your child, the safety belt must not be twisted.
- ⚠ **PAY ATTENTION!** Do not drive when the safety seat is in the location of 90° hover.

## 5.5 Forward-facing Installation 105–150cm Option 2

Usage: Only 3 Point Belt



1. Store the support leg 19:
  - A. Press and hold the adjustment button on the support leg 15, and stow the support leg;
  - B. Then lift the seat and fold the support leg back into the seat bottom groove;
  - C. Finally, push the front protruding part inward.

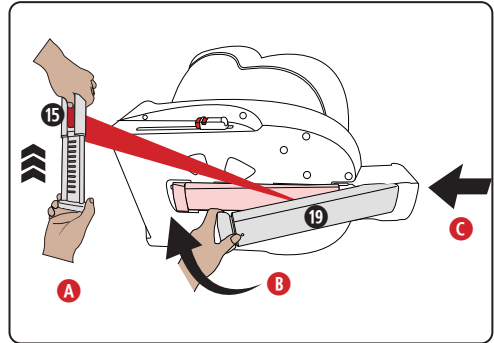

2. Put the child into the safety seat, adjust the headrest up and down according to the height of child.

See section 4.6 “Storing Shoulder Pads With Chest Pad And Buckle” on page 9 to remove the parts.

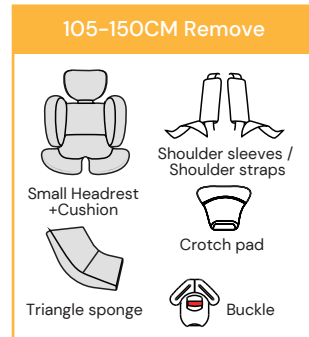
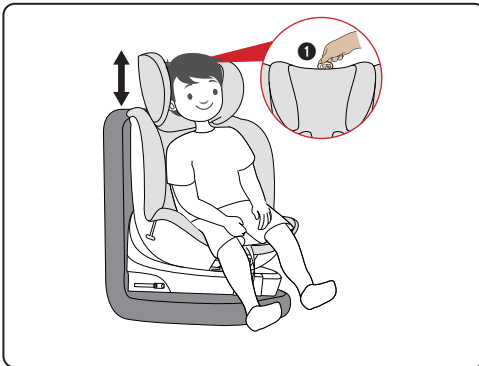



3. Pull out the adult 3-point belt:

- D. Clip the vehicle shoulder belt into the belt guide hook of the headrest, and then clip vehicle shoulder and lap belt together into the belt guide slot on the side of the seat, finally lock the buckle.

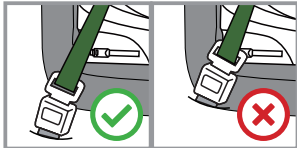
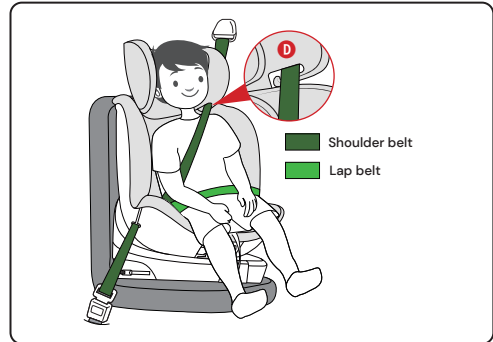

⚠ When using, it should be confirmed that the buckle of the adult 3-point belt does not interfere with the main load-bearing contact point of the child restraint system. If in doubt, please contact the manufacturer of the child restraint system.

- ⚠ On the premise of not causing discomfort to children, tighten the shoulder belt as much as possible.
- ⚠ The crotch strap should be as low as possible and should be located close to the crotch, not the abdomen.
- ⚠ To ensure the comfort of your child, the safety belt must not be twisted.
- ⚠ **PAY ATTENTION!** Do not drive when the safety seat is in the location of 90° hover.

## 6. Main Technical Parameters

Weight of the seat: 11.5±0.5kg

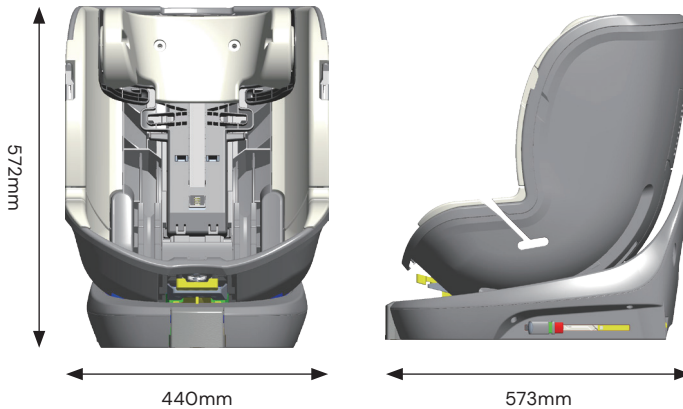

## 7. Maintenance And Cleaning

### 7.1 Daily Maintenance

- In daily use, check periodically the car seat. The car seat should be replaced after an accident.
- Please keep this car seat in a dry and ventilated place to avoid damp or mould.
- If the car seat becomes dusty, clean the seat belt and the plastic pieces by sponging them with a damp cloth and letting it dry before use.
- If food or drink is dropped accidentally on the buckle, disassemble the seat belt from the car seat and rinse it gently in warm water and leave it to fully dry before use.

### 7.2 Washing Instruction

**⚠** Never use any solvent, chemical detergent or lubricant on any part of your car seat.



Hand wash, water temperature below 30°C



Do not bleach



Dry clean, any solvent except trichloroethylene



Do not tumble dry



Do not iron

### 7.3 Remove and assemble the fabric cover

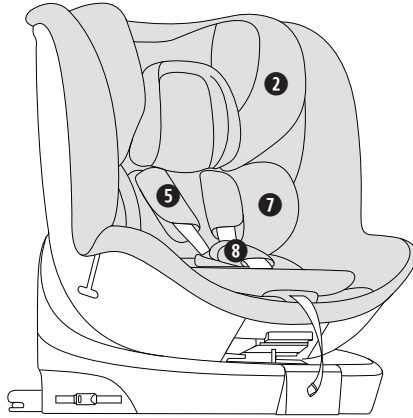

#### Disassembly Steps:

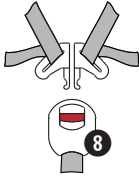

Remove the button first

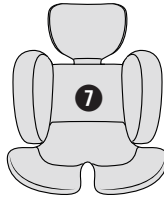

Take off the cushion

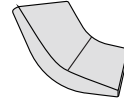

Take off the triangle sponge



Open both shoulder sleeves

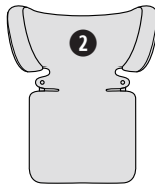

Remove the cover on the headrest

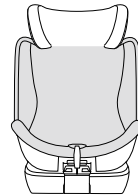

Finally, remove the cloth cover along the edge of the seat



 [amanababy.com](https://amanababy.com)

[hello@amanababy.com](mailto:hello@amanababy.com)

Imported by Millsons of London Ltd. EC1V 2NX

Made in China